

Haw Creek Twp
Bartholomew County

For Sale

105^{+/-} Acres

Productive Cropland with Rental House & Shed



PROPERTY INFORMATION

LOCATION
Stafford Road

ZONING
Agricultural

TOPOGRAPHY
Gently Rolling

SCHOOL DISTRICT
Flat Rock - Haw Creek Schools

TAXES
\$5,146.58



Dave Bonnell
Columbus, IN
812.343.4313
daveb@halderman.com



Michael Bonnell
Shelbyville, IN
812.343.6036
michaelb@halderman.com



HALDERMAN
REAL ESTATE & FARM MANAGEMENT
HLS# PDB-12323 (19)

800.424.2324 | halderman.com



HALDERMAN

REAL ESTATE & FARM MANAGEMENT

PO Box 297

Wabash, IN 46992

Haw Creek Twp
Bartholomew County

For Sale

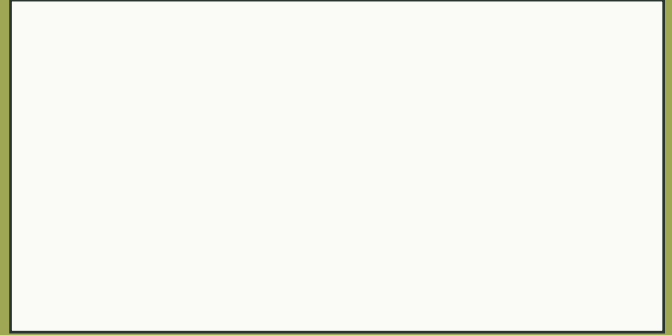

Productive Cropland with Rental House & Shed

105^{+/-} Acres

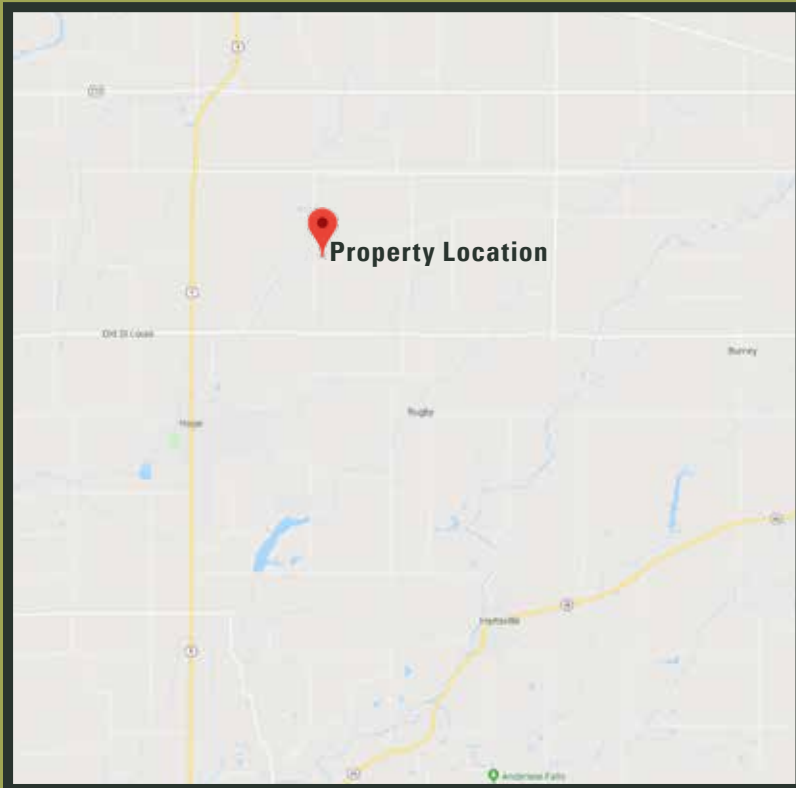

Soil Information



| Code | Soil Description <small>Field borders provided by Farm Service Agency as of 5/21/2008. Soils data provided by USDA and NRCS.</small> | Acres | Corn | Soybeans |
|-------------------------|---|-------|--------------|-------------|
| CudA | Crosby silt loam, 0 to 2 percent slopes | 60.94 | 138 | 46 |
| WufB2 | Williamstown silt loam, 2 to 6 percent slopes, eroded | 25.84 | 142 | 48 |
| MmoC3 | Miami clay loam, 6 to 12 percent slopes, severely eroded | 7.31 | 121 | 41 |
| CxdA | Cyclone silty clay loam, 0 to 2 percent slopes | 5.03 | 185 | 65 |
| Weighted Average | | | 140.2 | 47.1 |

